

UV365P1WE

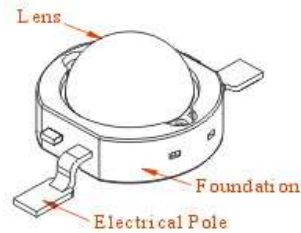

CAUTION
 OBSERVE PRECAUTIONS
 FOR HANDLING
 ELECTROSTATIC
 DISCHARGE
 SENSITIVE
 DEVICES

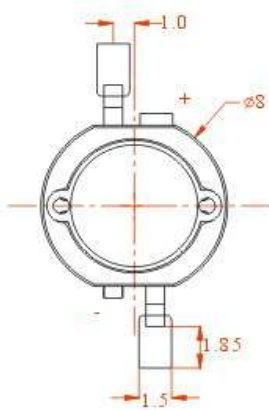
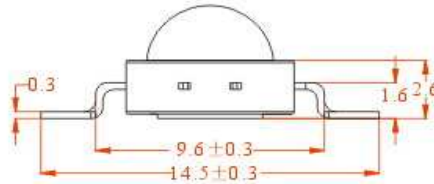
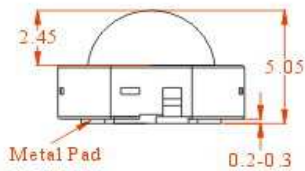

备注：产品照片及尺寸仅供参考，具体请以实物为准。

Note: Product picture & dimensions are for reference only. Detailed information is in accordance with the final product.

主要光电特性 (Ta = 25°C)

Typical Electrical & Optical Characteristics at Ta = 25°C

Items 项目	Symbo 符号	Condition 条件	Min. 最小值	Typ. 典型值	Max. 最大值	Unit 单位

TANK007 LIGHTING INC.

正向电流 Forward Current	IF	-	-	350	-	mA
正向电压 Forward Voltage	VF	IF = 350mA	3.8		4.6	V
输出功率 Optical output power (mW)	Iv1	IF = 350mA	10		20	mW
输出功率 Optical output power (mW)	Iv2	IF = 350mA	10		30	mW
输出功率 Optical output power (mW)	Iv3	IF = 350mA	20		30	mW
波长 Wavelength λ_p (nm)	λ_p	IF = 1000mA	365		375	nm
发光角度 50% Power Angle	$2\theta_{1/2}$	IF = 1000mA	-	120	-	deg

CHARACTERISTIC DIAGRAMS

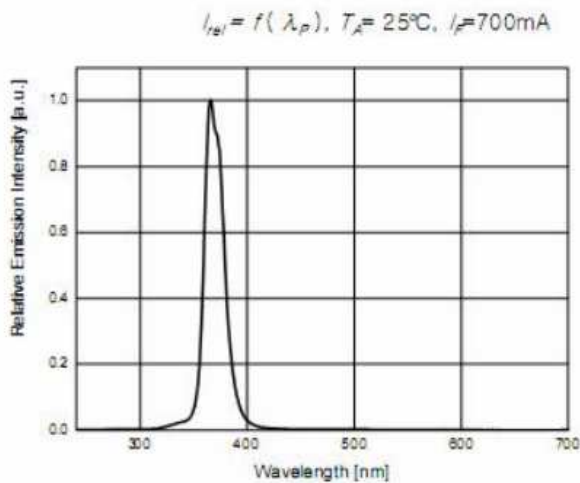

Wavelength Characteristics

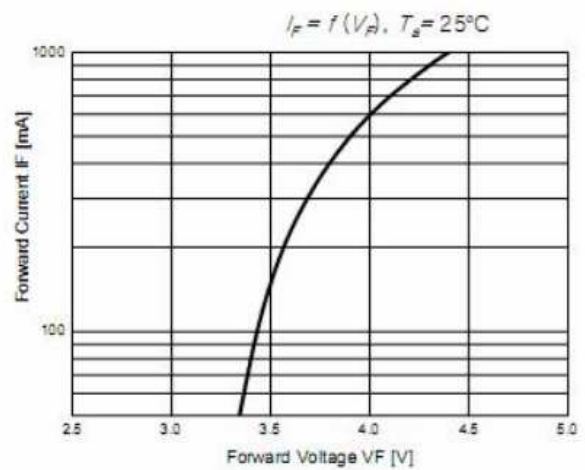

Forward Voltage vs. Forward Current

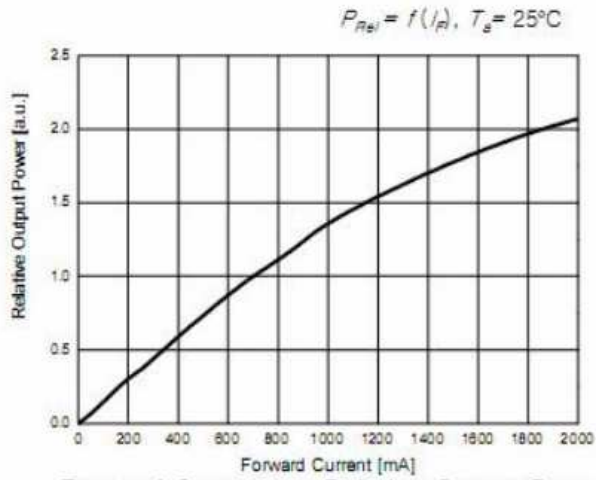

Forward Current vs. Relative Output Power

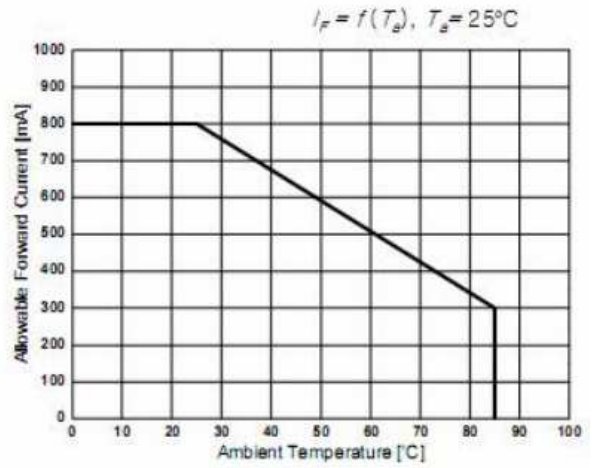

Ambient Temperature vs. Forward Current

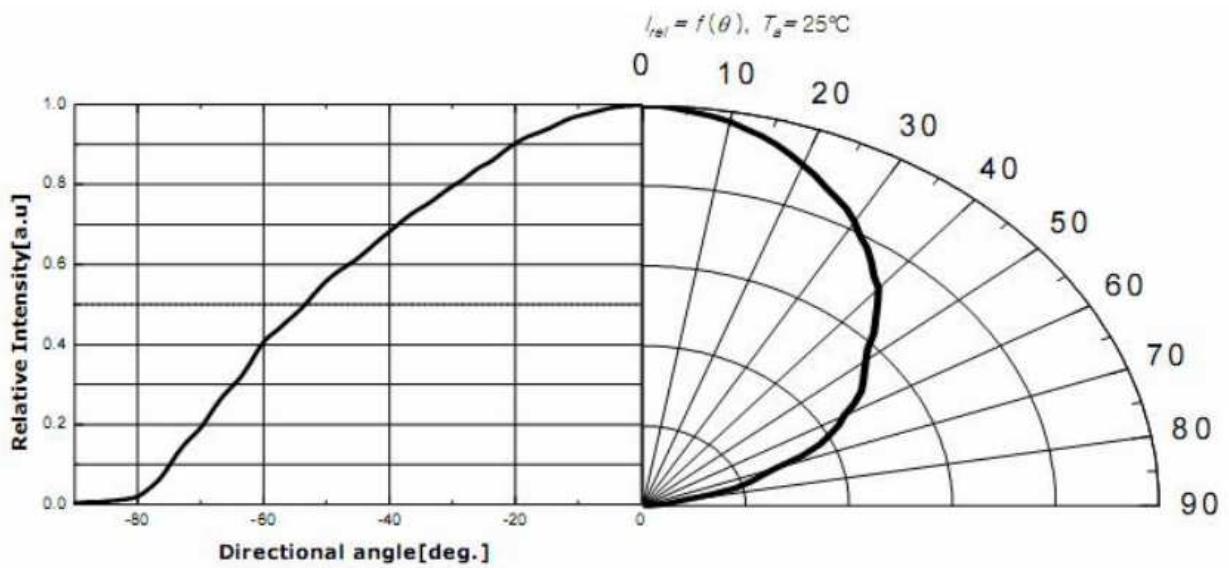

Off Axis Angle vs. Relative Output Power

极限參數值(Ta=25°C)

bsolute Maximum Ratings at Ta = 25°C

參數 Parameter	符号 Symbol	极限參值 Absolute maximum Rating	单位 Unit
反向电压 Reverse Voltage	V_R	5V	V
反向电流 Reverse Current	I_R	≤ 50	μA
功耗 Power Dissipation	P_D	1000	mW
工作温度 Operation Temperature	T_{opr}	-40 ~ +60	$^\circ\text{C}$
贮藏温度 Storage Temperature	T_{stg}	-40 ~ +100	$^\circ\text{C}$
焊接温度 Lead Soldering Temperature(5mm From The Base Of The Epoxy Bulb)	T_{sol}	260 ($\leq 3s$)	$^\circ\text{C}$
抗静电等级 Electrostatic Discharge Classification (MIL-STD-883E)	ESD	Class I	

*脉冲宽度小于等于 0.1msec, 占空比小于等于 1/10 Where pulse width \leq 0.1msec, duty cycle \leq 1/10