

# TH-UV395P3WJE (2 芯)

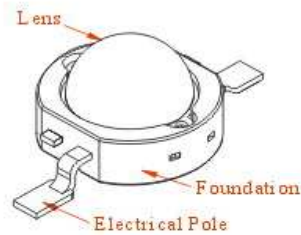

**TENTION**  
OBSERVE PRECAUTIONS  
FOR HANDLING  
ELECTROSTATIC  
DISCHARGE  
SENSITIVE  
DEVICES

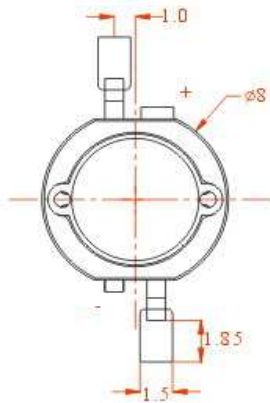
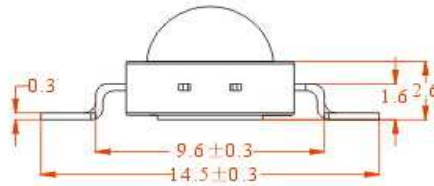
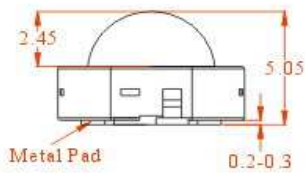

备注：产品照片及尺寸仅供参考，具体请以实物为准。

Note: Product picture & dimensions are for reference only. Detailed information is in accordance with the final product.

主要光电特性 (Ta = 25°C)

Typical Electrical & Optical Characteristics at Ta = 25°C

| Items<br>项目                       | Symbo<br>l符号 | Condition<br>条件 | Min.<br>最小值 | Typ.<br>典型值 | Max.<br>最大值 | Unit<br>单位 |
|-----------------------------------|--------------|-----------------|-------------|-------------|-------------|------------|
| 正向电流<br>Forward Current           | IF           | -               | -           | 700         | -           | mA         |
| 正向电压<br>Forward Voltage           | VF           | IF = 700mA      | 3.8         |             | 4.6         | V          |
| 输出功率<br>Optical output power (mW) | Iv1          | IF = 700mA      | 160         |             | 200         | mW         |
| 波长<br>Wavelength λ ρ (nm)         | λ ρ          | IF = 700mA      | 395         |             | 405         | nm         |
| 发光角度<br>50% Power Angle           | 2 θ½         | IF = 700mA      | -           | 120         | -           | deg        |

极限參数值(Ta=25°C)

bsolute Maximum Ratings at Ta = 25°C

| 参数 Parameter   | 符号 Symbol | 极限參值 Absolute maximum Rating | 单位 Unit |
|--|-----------|------------------------------|---------|
| 反向电压 Reverse Voltage   | VR        | 5V                           | V       |
| 反向电流 Reverse Current   | IR        | ≤50                          | μA      |
| 功耗 Power Dissipation   | PD        | 3000                         | mW      |
| 工作温度 Operation Temperature   | Topr      | -40 ~ +60                    | °C      |
| 贮藏温度 Storage Temperature   | Tstg      | -40 ~ +100                   | °C      |
| 焊接温度 Lead Soldering Temperature(5mm From The Base Of The Epoxy Bulb) | Tsol      | 260 (≤3s)                    | °C      |
| 抗静电等级 Electrostatic Discharge Classification (MIL-STD-883E)          | ESD       | Class1                       |         |

\*脉冲宽度小于等于 0.1msec, 占空比小于等于 1/10      Where pulse width ≤ 0.1msec, duty cycle ≤ 1/10